



Module II. Technical

Comics Course

Topic 1. Understanding Comics

Lesson 2. From strip to page



Co-funded by the
Erasmus+ Programme
of the European Union

In this lesson, we will learn...

What is the functionality of composition and the use of the grid as a narrative tool



Co-funded by the
Erasmus+ Programme
of the European Union



Panel is the single box, rectangular or square, which contains image and text together.

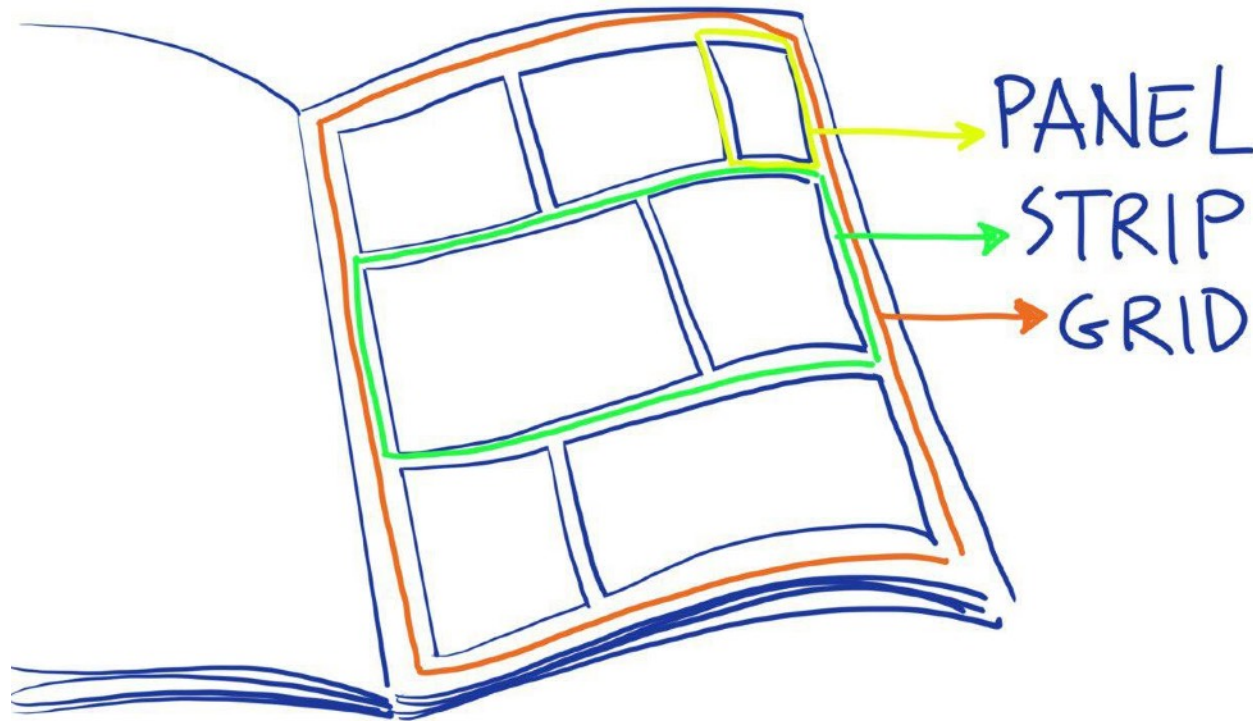

Strip is the set of several panels, from a minimum of two to a maximum of X, (depending on the size of the page) arranged on the same horizontal line.

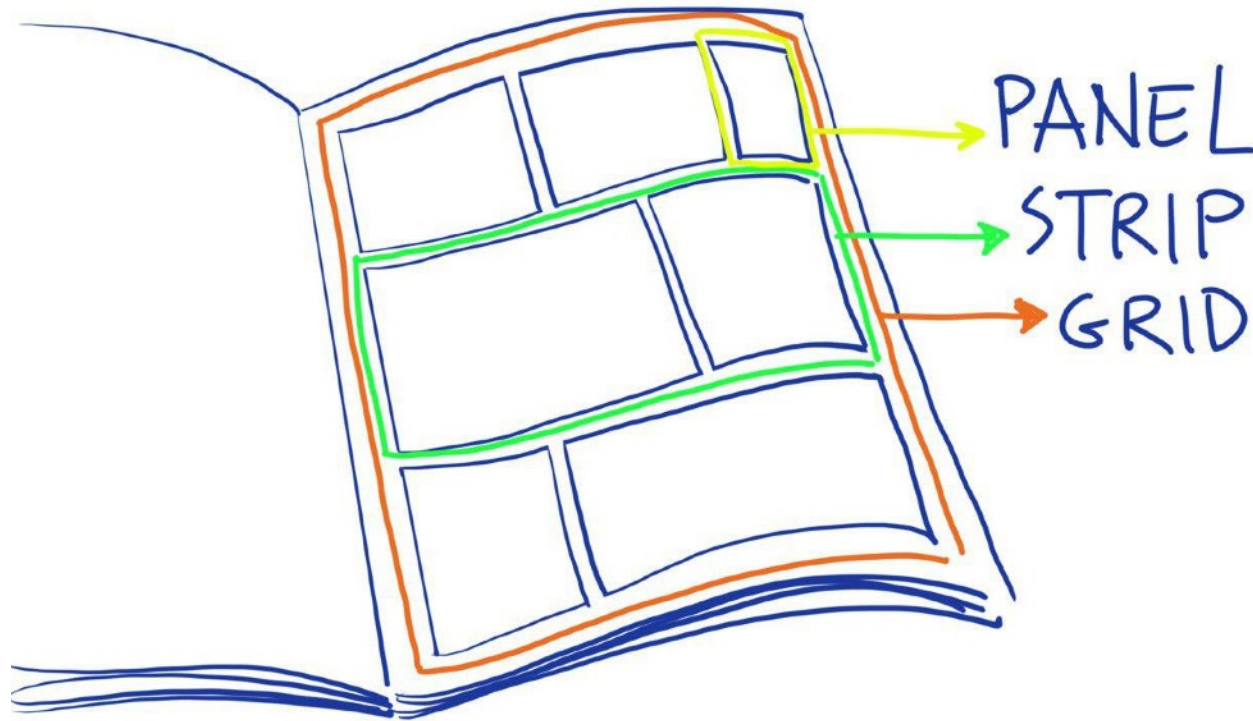

Grid is the composition of several strips within the page.

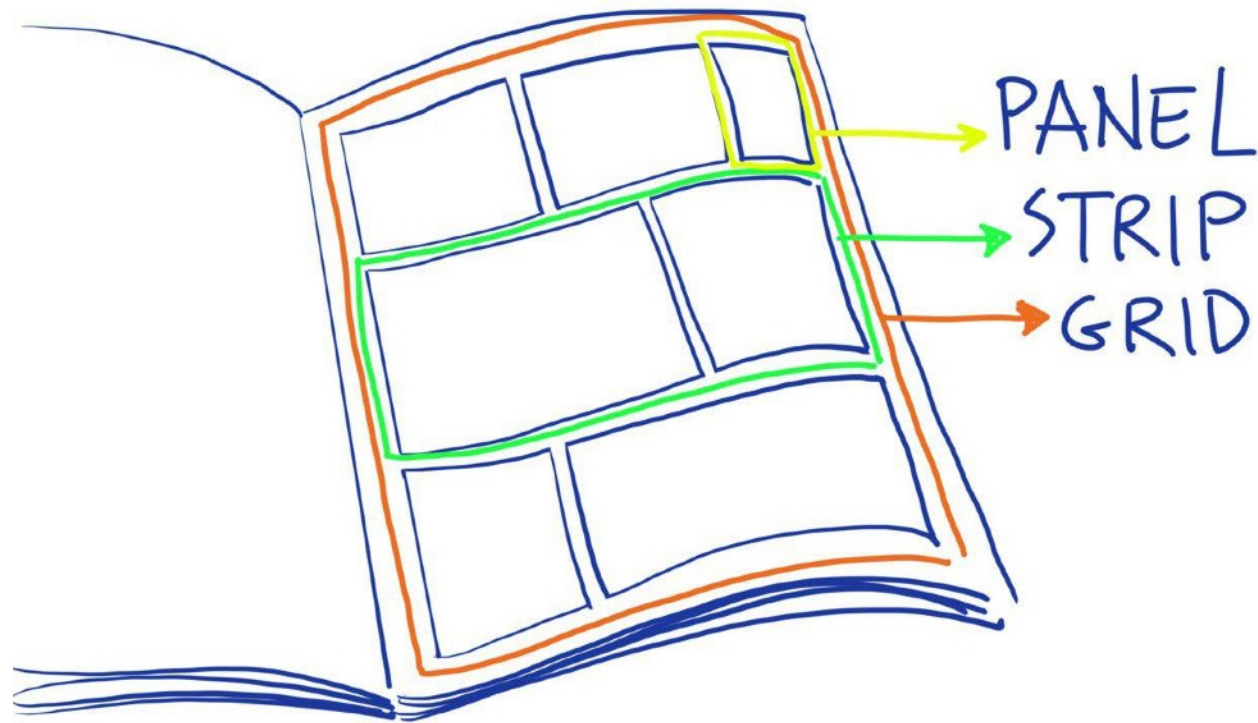

Publishers have often imposed standards, both in the formats and obviously in the grid, in order to maintain maximum clarity and reach the widest possible audience.

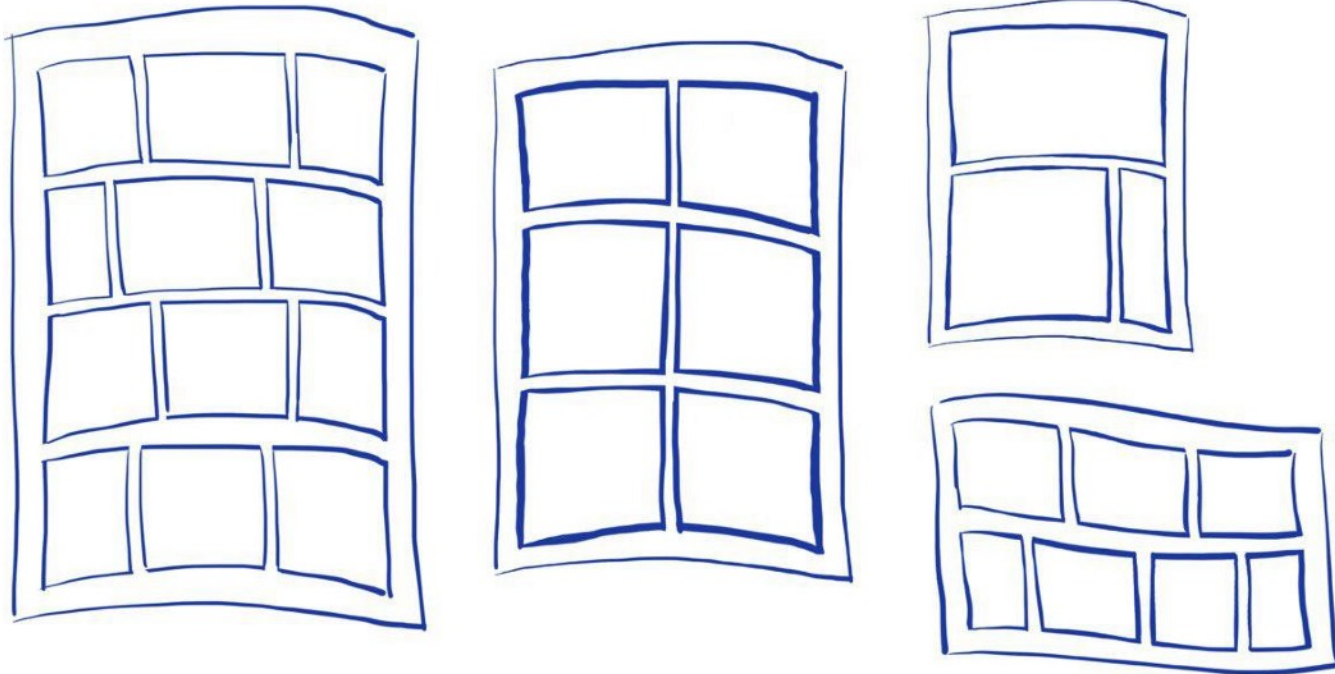

A PAGE
FROM
"LIFE
ON
ANOTHER
PLANET"
1980

WILL
EISNER

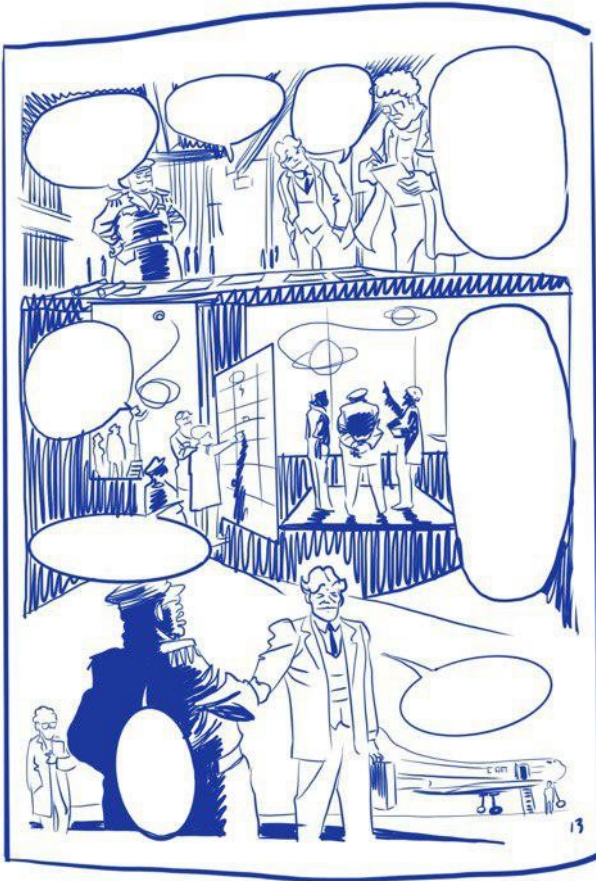

GHOST
GRID

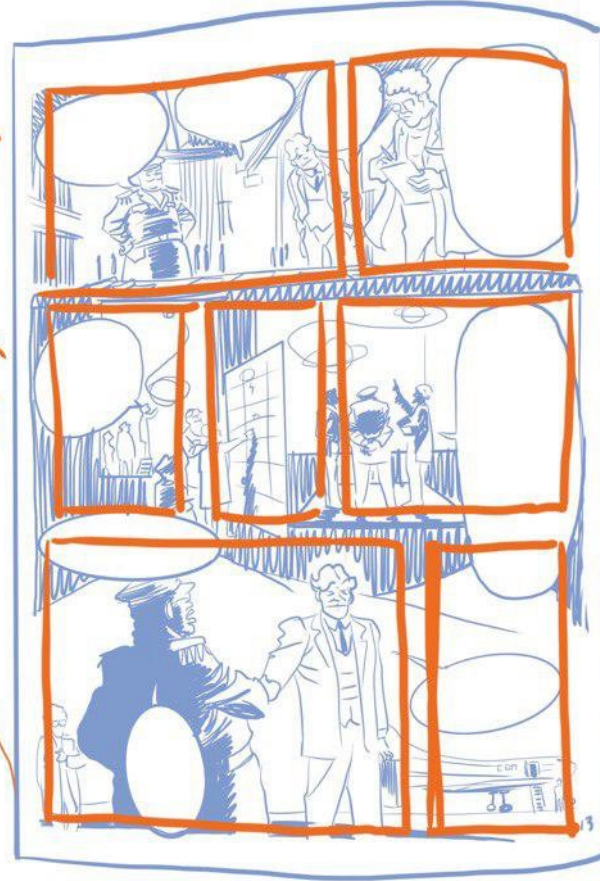

The master Will Eisner showed how there are no rigid rules on grid composition, the important thing is clarity in communication.

Despite the absolute freedom and lack of defined contours for the panels, legibility is not lost



Co-funded by the
Erasmus+ Programme
of the European Union



Jack Kirby used pre-set grids of 4 to 9 panels which he used as a basis for drawing the stories. It's a bit like a ruled sheet of paper on which to write text by hand, with a few exceptions.

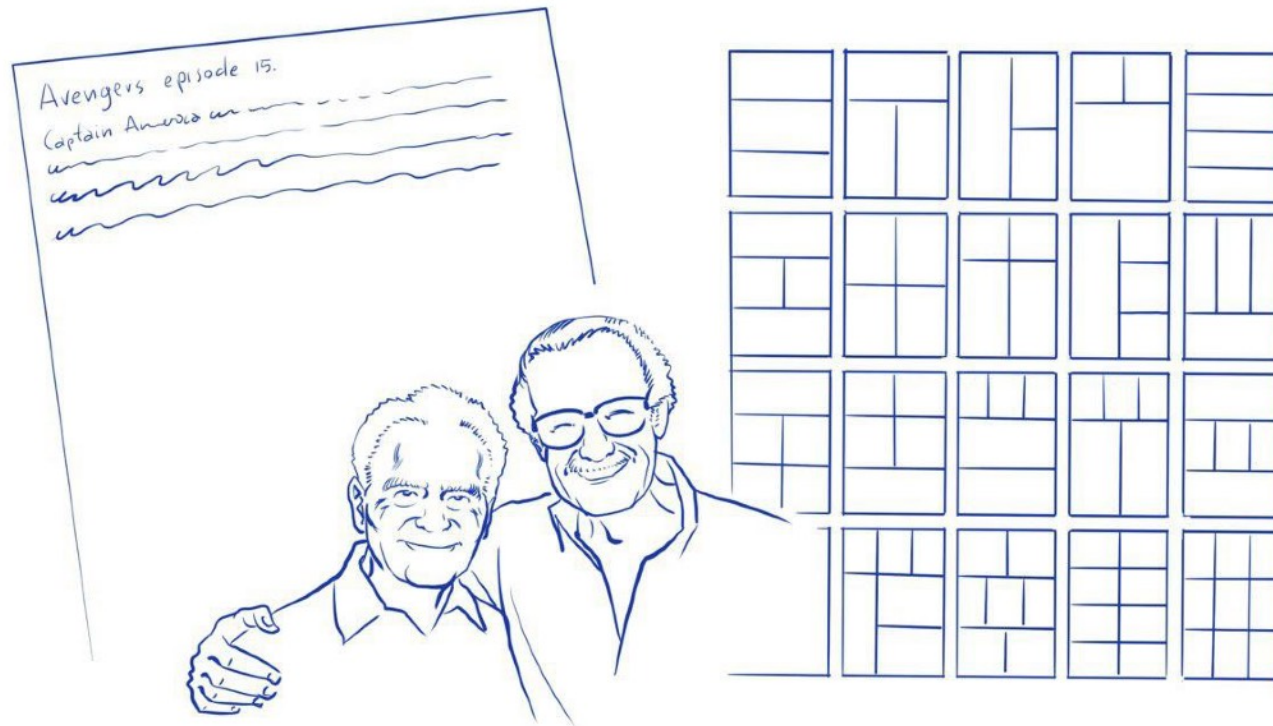

Co-funded by the
Erasmus+ Programme
of the European Union

The space available, together with the typographic technical characteristics, influence the choice of a grid.

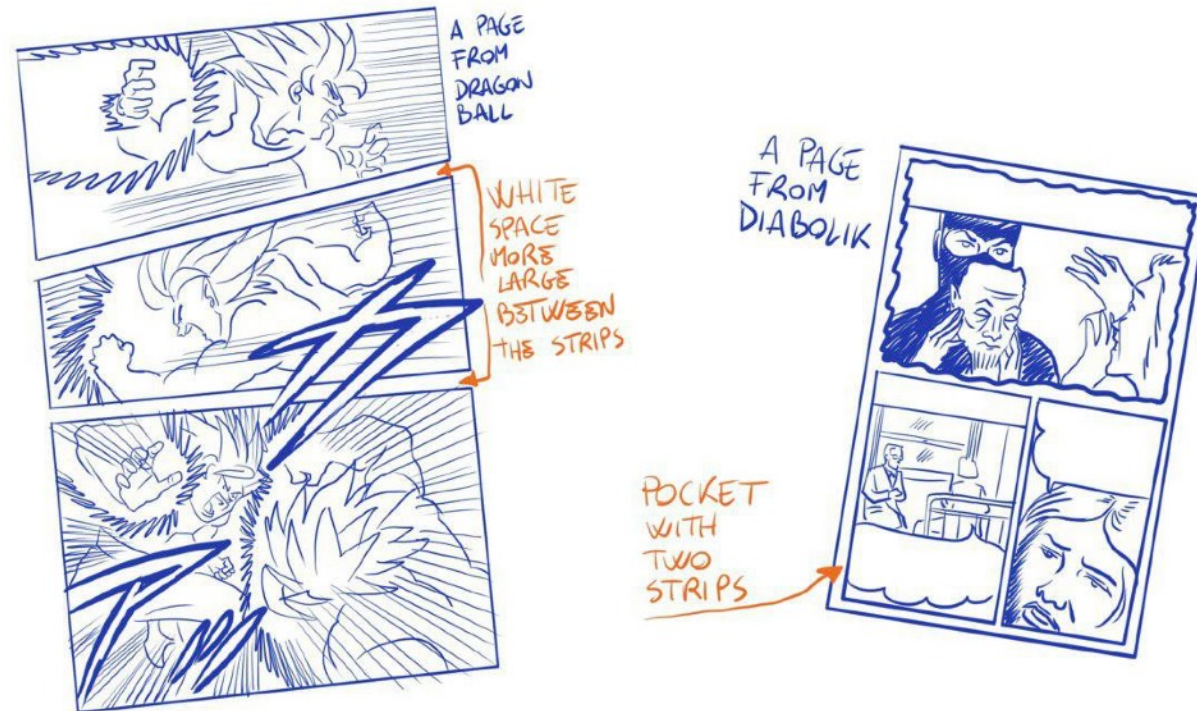

In conventional comics the panel frame also has a function that the reader recognises. Rounded margins, unlike regular margins, communicate a moment in the past or a flashback

PANEL REGULAR TIME

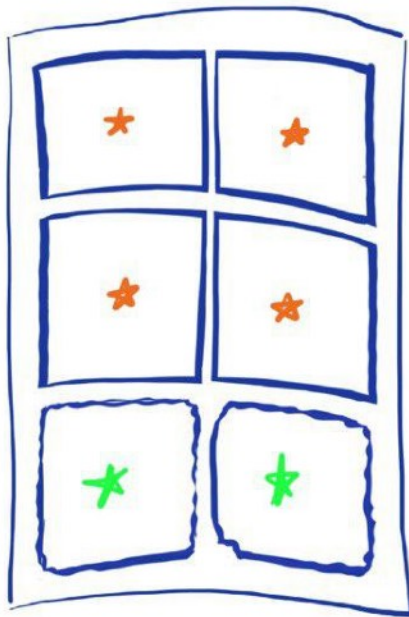

FLASHBACK/DREAM PANEL

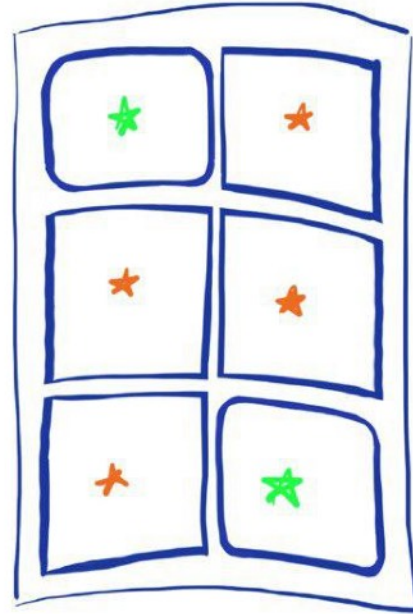

Space seems to influence the perception of time in comics.
Because if it is true that a small panel seems to describe a moment, a larger one seems to dilate it.



Co-funded by the
Erasmus+ Programme
of the European Union

Conclusions

If each panel represents a moment, several panels with a representation of the same moment, do not necessarily suggest a prolonged perception of time.

On the contrary, they risk fragmenting that moment in a schizophrenic way.



Co-funded by the
Erasmus+ Programme
of the European Union



CREDITS

Content: Danilo Barbarinaldi
Voice: Nicola Clemente



Co-funded by the
Erasmus+ Programme
of the European Union

